

Technical Data Sheet

CONTOUR 700mm Wall Mounted Unit

Whats in the box: 1x CN7011.X

R2

*Reference basin TDS for further info

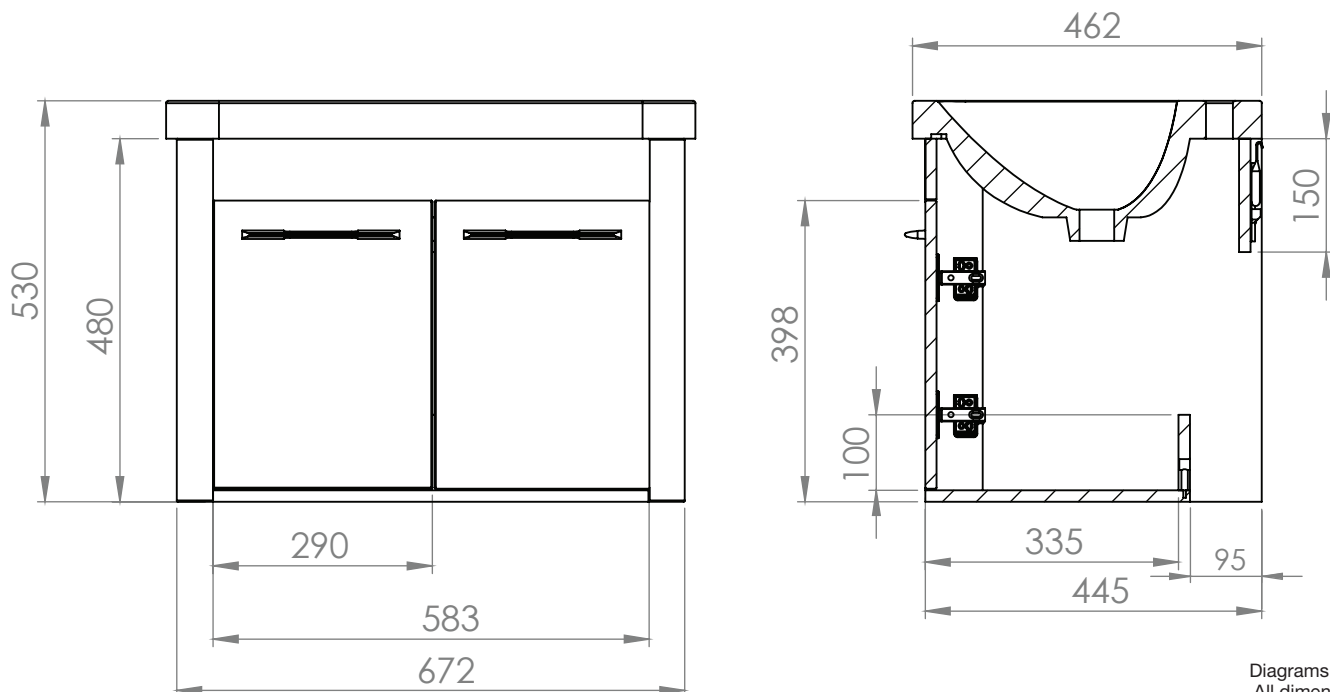

Diagrams not to scale
All dimensions in mm
tolerance of +/-5mm

Materials

Carcass: 16mm Painted & Melamine Faced MDF

Fascia Components: 16mm Painted MDF

**Dimensions are subject to change, customers are advised to measure actual product before commencing installation.

***Fixing point dimensions are for guidance only/the positions of wall fixing must be checked when product is received.

FAQs

Q: How big is the plumbing void?

A: 95mm.

Q: Are the handles fitted?

A: No, handles need fixing. Holes are pre-drilled.

Q: How far apart are the hole centres for the handles?

A: 160mm.

Q: Are the hinges soft close?

A: The hinges are both soft close and quick release.

Q: Can the doors be adjusted?

A: The doors can be adjusted as detailed in the supplied instructions.

Q: How deep is the unit with doors open?

A: Approx 735mm at 90°.

Q: What is the shelf capacity?

A: Base max depth: 335mm.

Q: How many shelves are there?

A: There is no shelf but a base inside the unit.

Q: What is the interior finish of the unit?

A: The unit interior is the same finish as the exterior.

NOTE: Colours unique to Roper Rhodes - No RAL Code available