

Soul

600 Floor Mounted Unit SL6010.x

Please retain for future reference

R2

Installation and Fitting Instructions

Before you start

It is recommended that the unit and basin are secured to a suitably reinforced wall to ensure stability. Place the furniture unit in the desired position. Secure unit to the wall through the pre-drilled holes in the rear brace using fixings suitable for the wall surface (not supplied). If in any doubt please consult an expert.

Wear suitable eye protection when drilling. Take care when using power tools near water - the use of a residual current device (RCD) is recommended. Beware of hidden pipes or cables. Take care when drilling tiled surfaces as the drill might slip. Use a piece of masking tape to prevent the drill from wandering.

Fitting Basin





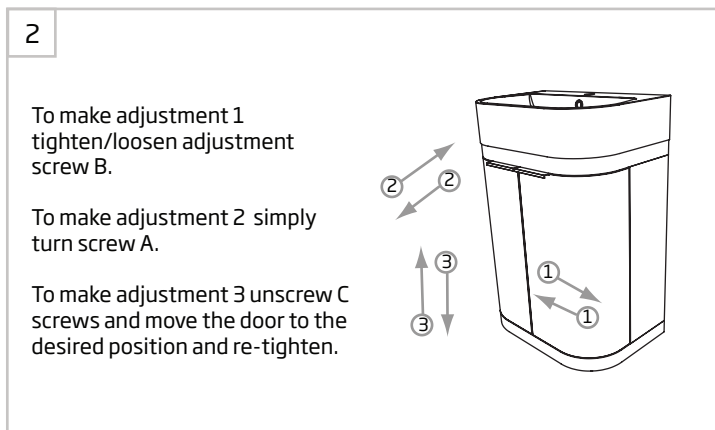
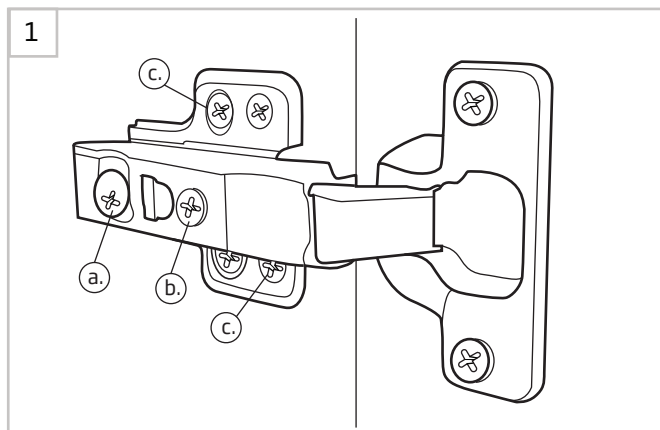

Once the basin is plumbed in finish by securing to the washstand with a silicone sealant (not supplied).

Hinge Adjustment

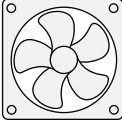

Furniture Aftercare Instructions

As with all wooden furniture, this unit should be treated with care:

We recommend...	Please DO NOT...
<div></div> <div>Wipe away any water splashes or condensation after use. Excessive exposure to water will deteriorate the furniture.</div>	<div></div> <div>Do not scrub or scour</div>
<div></div> <div>All bathrooms should be well ventilated with a suitable extractor fan.</div>	<div></div> <div>Do not use abrasive cleaning agents</div>
<div></div> <div>Clean with a soft damp cloth only.</div>	
<div></div> <div>Use a wax free polish if one must be used.</div>	
<div></div> <div>For removal of lime scale deposits use a suitable proprietary cleaner. If necessary test on an inconspicuous area first.</div>	

Replacement components
Should you require any replacement components for this product please contact Roper Rhodes Ltd using the contact details below.

Isocast Basin Aftercare Instructions

The isocast basin is made of a non-porous material and as such it can be wiped clean with a damp cloth or sponge using mild detergents or soapy water. DO NOT use abrasive cleaning solutions. Where possible avoid sliding hard or sharp objects on the surface to prevent scratches. Strong acids such as those found in drain cleaners, toilet cleaners, paint removers and cleaners containing methylene chloride or acetone (nail polish remover) should be used very cautiously around the isocast material. Should this product come in contact with the surface, quickly flush the surface with plenty of soapy water. Any residue and spills from, shampoo, toothpaste, mouthwash, etc. should be cleaned immediately with soapy water to ensure no damage occurs.

The top surface of the basin consists of ISO polyester and aluminium trihydrate with a thickness of approx. 1,0-2,0mm. The substrate material is a polyester/calcium carbonate made up to about 13mm total thickness.

Regular cleaning should be done with sponge which is delivered with your basin (or available in your everyday supermarket store) and regular cleaning detergent. A combined cleaning and polishing product is available called Clean & Shine. This will keep the Isocast material in peak condition. Do not use acids, ammonia, chlorine or other strongly corroding products on the surface of Isocast. Scratches and small defects can be removed with wet sandpaper (1200) or by use of a Scotch-Brite green sponge. The top white layer is 1-2mm thick so care must be taken to remove the minimum material when re-finishing.



Customer Services
R2
Brassmill Lane Trading Estate
Bath
BA1 3JF
t: 01225 303900