

Technical Data Sheet

Array Modular Furniture

600mm Drawer Units

TAVISTOCK
inspiring bathrooms

No.	Description	Code	Fixings Included	Gross Weight	Net Weight
1	600mm Top Drawer Unit	ATD600XX	YES		
2	600mm Bottom Drawer Unit	ALD600XX	YES		



Dimensions

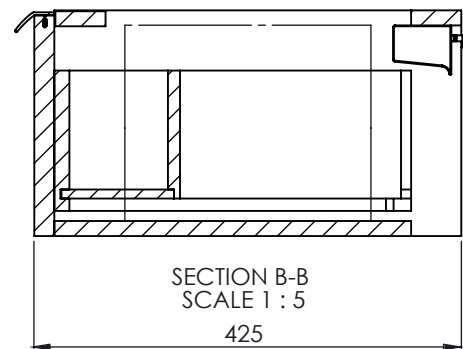
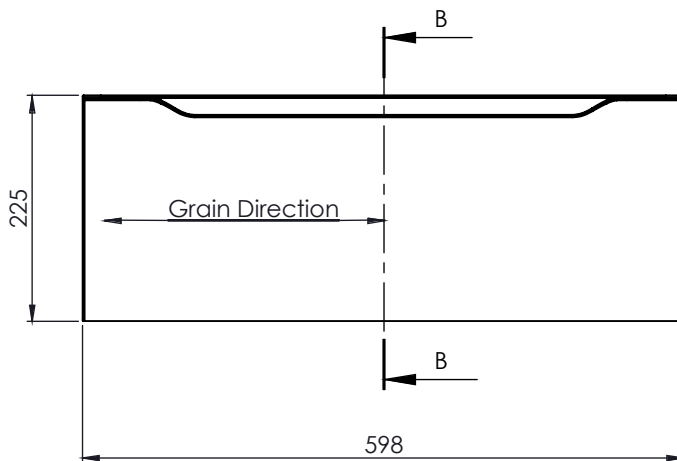

Diagrams not to scale
All dimensions in mm
tolerance of +5mm

FAQ's

What differences are there between the two drawer units? - The top unit has a cutout in the drawer to allow the unit to be positioned underneath a basin and accommodate the trap and plumbing. The bottom unit has no cutout, providing more storage space.

How are the units attached to each other? - The units are attached vertically with the fittings provided. Full fitting instructions are provided with each unit.

Technical Data Sheet

Array Modular Furniture

300mm & 600mm Open Drawer Units

TAVISTOCK
inspiring bathrooms

No.	Description	Code	Fixings Included	Gross Weight	Net Weight
1	600mm Open Shelf Unit	AOU600XX	YES		
2	300mm Open Shelf Unit	AOU300XX	YES		



1.

2.

Dimensions - (600mm Unit Shown)

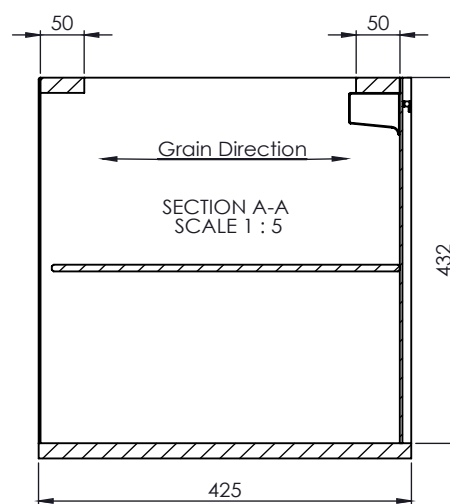
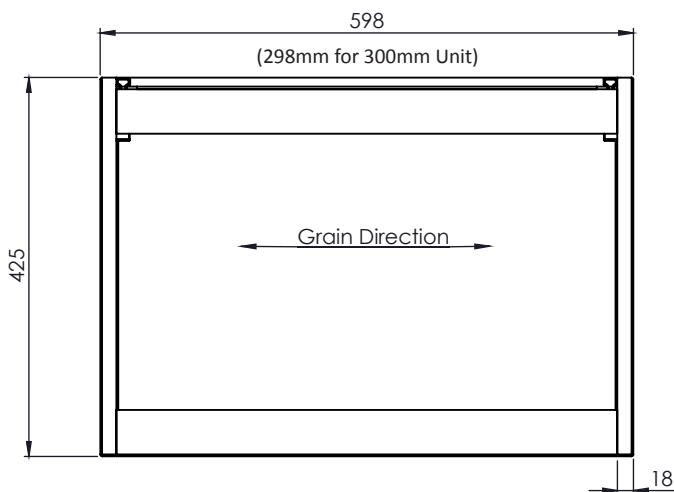

Diagrams not to scale
All dimensions in mm
tolerance of +5mm

FAQ's

How deep is the shelf? - The shelf is approximately 220mm from the top and bottom of both units and is 8mm thick.

Technical Data Sheet

Array Modular Furniture

600, 900 & 1200 Isocast Worktops

TAVISTOCK
inspiring bathrooms

No.	Description	Code	Fixings Included	Gross Weight	Net Weight
1	600mm Isocast Worktop	AT600W	N/A		
2	900mm Isocast Worktop	AT900W	N/A		
3	1200mm Isocast Worktop	AT1200W	N/A		



Dimensions - (600mm Worktop Shown)

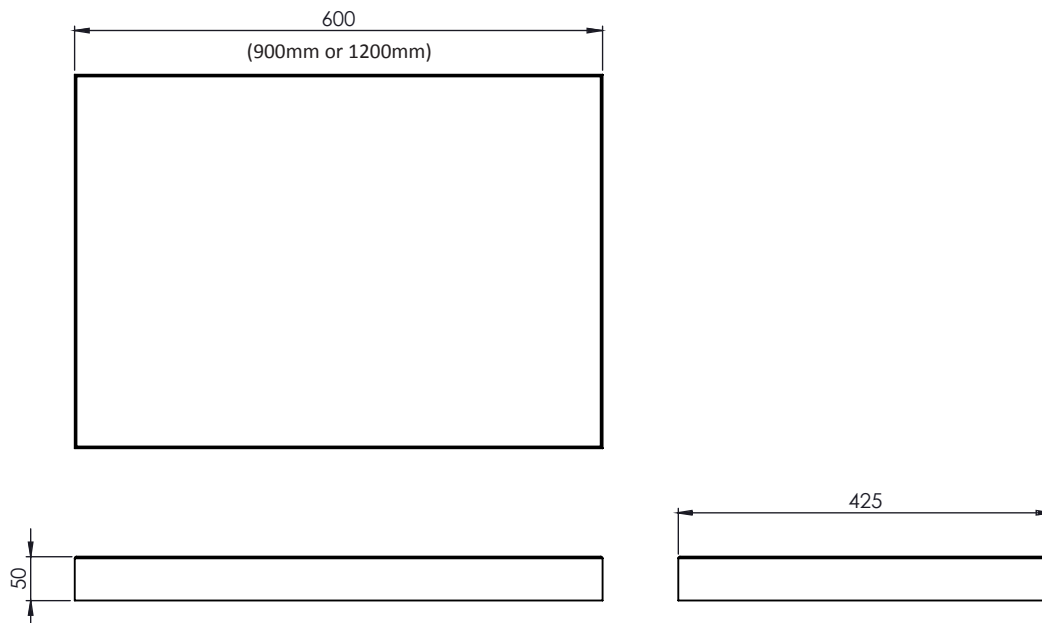

Diagrams not to scale
All dimensions in mm
tolerance of +5mm

FAQ's

When the basin is on the worktop, how far is it from the edge of the worktop? - The basin will sit approximately 25mm from the front edge of the worktop and 25mm from the side edge. The back of the basin is flush with the wall.

Technical Data Sheet

Array Modular Furniture

550mm Isocast Basin

TAVISTOCK
inspiring bathrooms

No.	Description	Code	Fixings Included	Gross Weight	Net Weight
1	550mm Isocast Basin	AB550W	N/A		



Dimensions

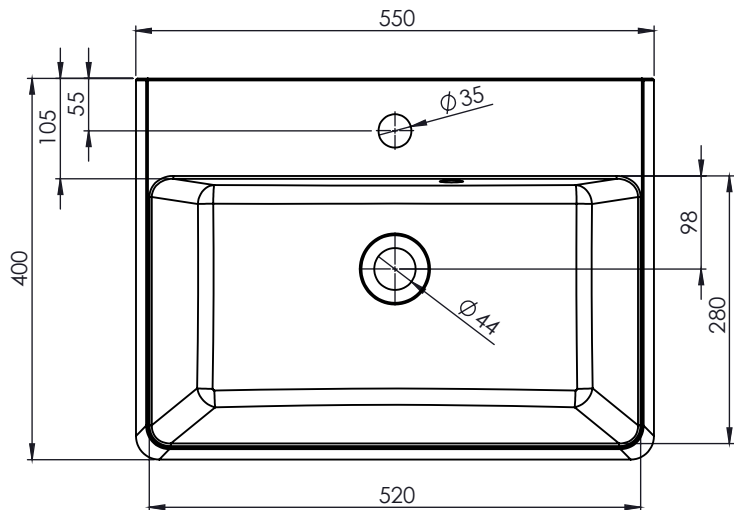

Diagrams not to scale
All dimensions in mm
tolerance of +5mm

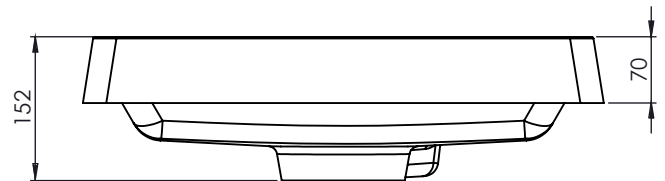

FAQ's

What is the maximum depth of water in the basin? From the bottom of the basin to the overflow is approx 60mm.

Technical Data Sheet

Array Modular Furniture

Possible Furniture Combinations & Important Information

IMPORTANT INFORMATION

- For 900mm combinations, it is important that the basin is positioned above a top drawer unit (ATD600) as the drawer box is designed to allow the plumbing to be connected below. The basin cannot be positioned above an open shelf unit (AOU300, AOU500) as the basin can only be centrally mounted above a drawer.
- For drawer units that are not positioned below a basin (such as in combination 7), a bottom drawer unit (ALD600) can be used to create more storage as the bottom drawer unit does not contain a cutout for plumbing.
- For the top drawer units with plumbing cutout in the drawer, it is important that a low profile trap is used with this unit. This prevents the trap from interfering with the drawer below and allows other drawer units to be attached unimpeded.

POSSIBLE FURNITURE COMBINATIONS

As a modular furniture range, Array furniture can be combined to form a number of different combinations of varying sizes. Each combination has a 550mm basin, a worktop and at least one drawer unit. Any units underneath basins need to be a Top Drawer Unit (ATD600) to allow for plumbing. Any drawer units underneath another drawer unit or not underneath a basin should be a Bottom Drawer Unit (ALD600). The combinations we recommend are shown below:

