Technical Data Sheet

Product Code: NO50AL , NO65AL

Product name: NOOK

TAVISTOCK
inspiring bathrooms



Nook Single Door
NO50AL



Nook Double Door
NO65AL

Features

- LED Technology
- IR Sensor
- IP44 Rated
- Double Sided Mirror Door(s)
- 2 x Adjustable Shelves
- Recessed or Surface Mount

Dimensions - NO60AL

Internal Dimensions: 578 w x 550 h x 96 d

Diagrams not to scale
All dimensions in mm
tolerance of +5mm

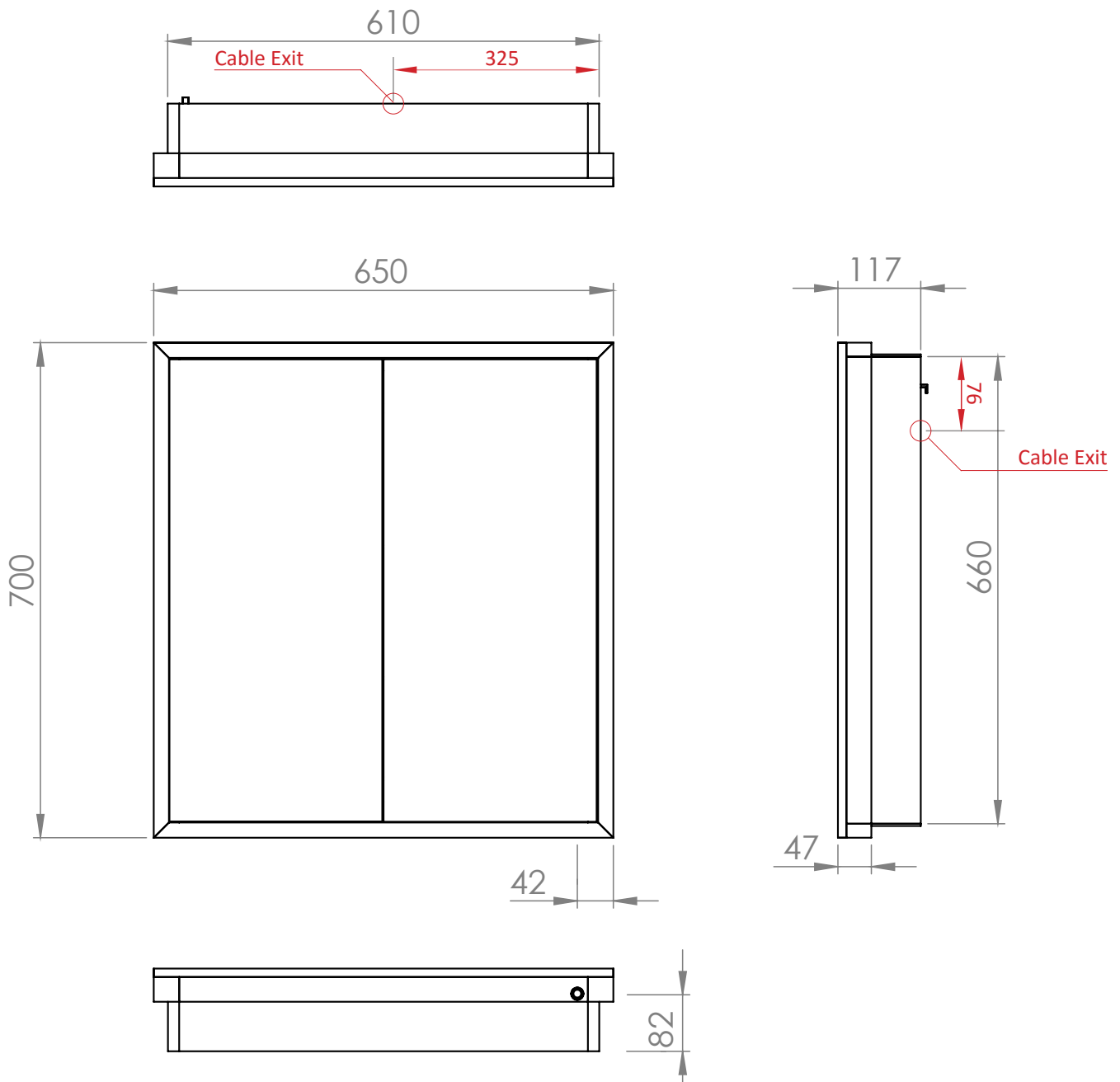

Dimensions - NO50AL

Internal Dimensions: 428 w x 550h x 96 d

Diagrams not to scale
All dimensions in mm
tolerance of +/- 5mm

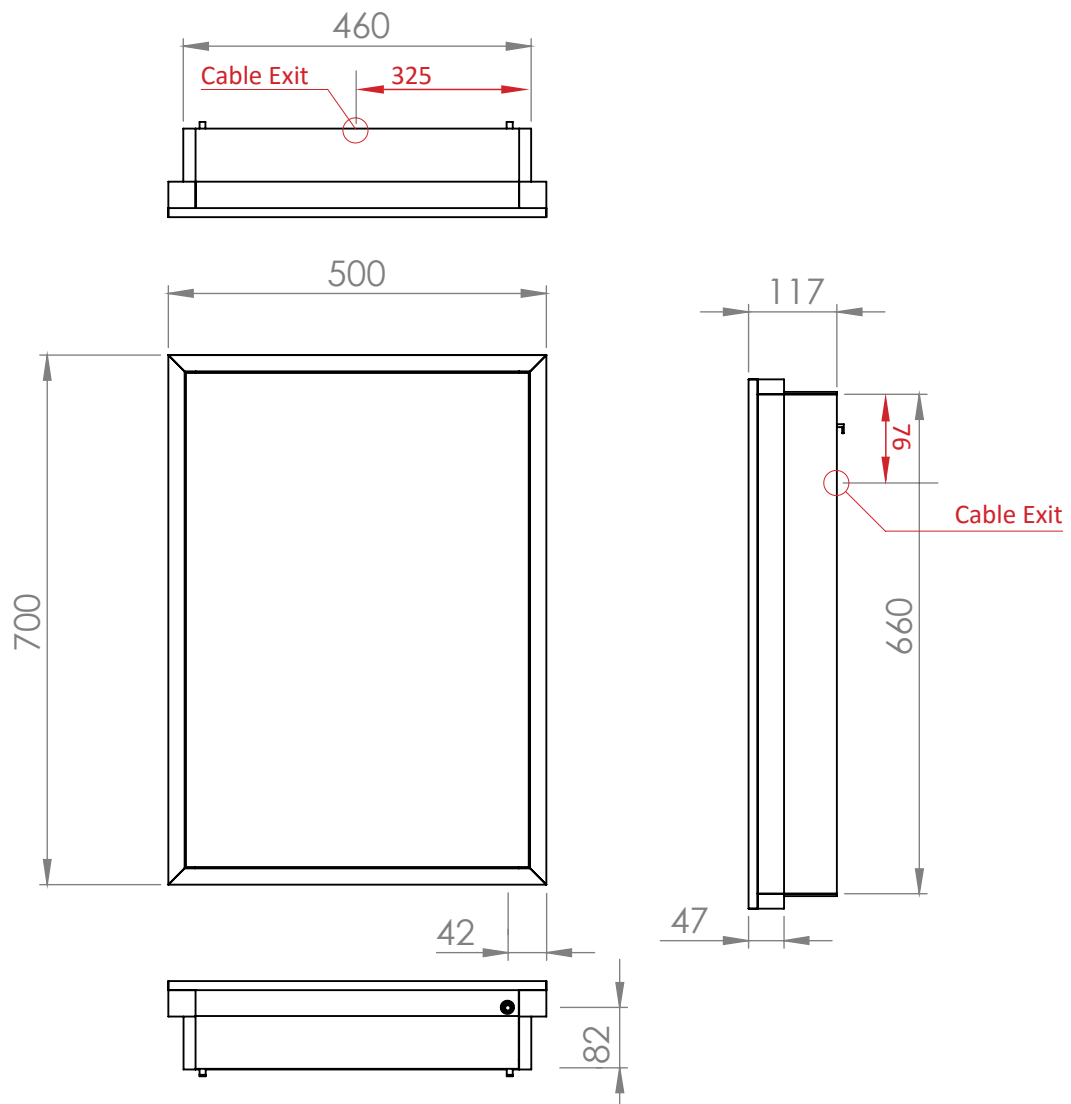

FAQ's

Is the Cabinet IP44 rated? Yes it can be placed in Zone 2.

Can the doors be adjusted? Yes refer to installation instruction provided with product

What is the thickness of the mirror glass door? 6mm.

Can the mirror doors be reversed? No

What size fuse should I use? We cannot recommend fuse size as each installation is different a qualified Electrician should be consulted in accordance with IEE 7671

Is the cabinet fitted with a mains cable? Yes the cable length is approximately 500mm.

What is the wattage of the light? Single Door = 22.5 Watts, Double Door = 25.4 Watts

Can the LED lighting be replaced? Yes we offer spares and instruction on how to replace them.

Does the cabinet have an energy rating? The mirror has an energy rating for the LED lighting used only in accordance with EU 874-2012. This LED's used in this product are rated is 'A'.

Does the Cabinet have a shaver socket? Yes it is located in the top right hand corner of the cabinet.

How do I operate the shaver socket? There is a rocker switch to the left of the shaver socket

Where is the IR sensor located? Refer to drawings above.

Can the IR sensor be re-positioned? No

How do you fix the Cabinet to the wall? The cabinet can be surface mounted or recessed please refer to installation instructions for more information.

How many Glass shelves does the cabinet have? 2, size: 415 x 88 x 5mm (single) 565 x 88 x 5mm (double).

Are the shelves adjustable? Yes they can be positioned to any height by adjusting the shelf bracket screw.

What are the internal dimensions of the cabinet? Please refer to above drawing.